

EASI-PLAN®

Deco Flush Plate

ref: EPPR-05-05CP / EPPR-05-05SA / EPPR-05-05WH

Parts supplied

- A 1 x Deco Press Panel
- B 1 x Fixing Mount for 0.82/0.98m Cistern
- C 2 x Round Head Screw

Tools required (not supplied)

- Screwdriver PH3
- Flat Bladed Screwdriver
- Retractable Blade Knife

Important Information

PLEASE READ THESE INSTRUCTIONS THOROUGHLY BEFORE STARTING INSTALLATION.

Check the pack and make sure you have all the parts listed.

This Flush Plate can be used in conjunction with the following Easi-Plan Frames:

EPWC-05-1005
EPWC-05-1505
EPWC-25-1005
EPWC-25-1505



Step 1

Discard the blanking plate from Corrugated Tile Guide & Flush Plate Mount and cut down the Corrugated Tile Guide & Flush Plate Mount so that it is flush with the tile using a Retractable Blade Knife.

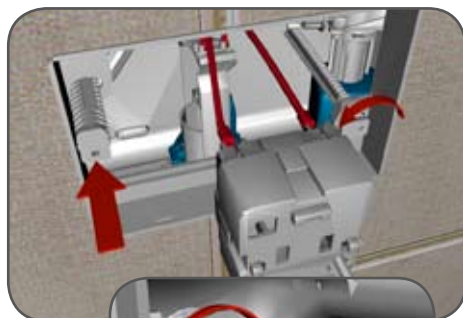

Step 2

Locate two White Nylon Rods attached to the Corrugated Tile Guide fitted during the installation of the WC Frame. Unclip each by rotating the White Nylon Rod a quarter turn anticlockwise. These should then be adjusted so that they are approx 5mm back from the front face of your tile. Fix them back into position with a quarter turn anticlockwise.

At this stage you can now activate the water supply to the frame at the isolation valve within the cistern either by hand or with a flat bladed screwdriver.

EASI-PLAN®

Deco Flush Plate

ref: EPPR-05-05CP / EPPR-05-05SA / EPPR-05-05WH

Parts supplied

- A 1 x Deco Press Panel
- B 1 x Fixing Mount for 0.82/0.98m Cistern
- C 2 x Round Head Screw

Tools required (not supplied)

- Screwdriver PH3
- Flat Bladed Screwdriver
- Retractable Blade Knife

Important Information

PLEASE READ THESE INSTRUCTIONS THOROUGHLY BEFORE STARTING INSTALLATION.

Check the pack and make sure you have all the parts listed.

This Flush Plate can be used in conjunction with the following Easi-Plan Frames:

EPWC-05-1005
EPWC-05-1505
EPWC-25-1005
EPWC-25-1505



Step 1

Discard the blanking plate from Corrugated Tile Guide & Flush Plate Mount and cut down the Corrugated Tile Guide & Flush Plate Mount so that it is flush with the tile using a Retractable Blade Knife.

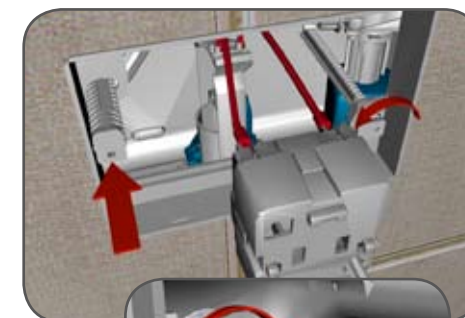

Step 2

Locate two White Nylon Rods attached to the Corrugated Tile Guide fitted during the installation of the WC Frame. Unclip each by rotating the White Nylon Rod a quarter turn anticlockwise. These should then be adjusted so that they are approx 5mm back from the front face of your tile. Fix them back into position with a quarter turn anticlockwise.

At this stage you can now activate the water supply to the frame at the isolation valve within the cistern either by hand or with a flat bladed screwdriver.

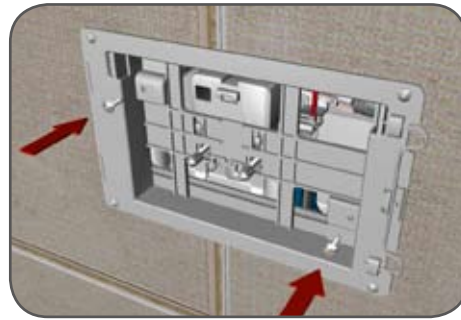
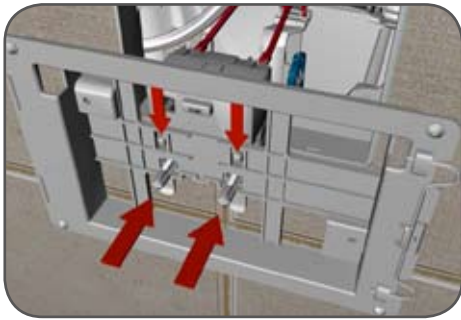

Step 3
Locate the Push Mechanism Box (connected by two wires to the Siphon within the Cistern) and clip the Push Mechanism Box to the Fixing Mount for 0.82/0.98m Cistern (B) by means of the three location slots on the Fixing Mount for 0.82/0.98m Cistern (B).

Step 4
Attach the Fixing Mount for 0.82/0.98m Cistern (B) to the two White Nylon Rods using 2 No. Round Head Screws (C).

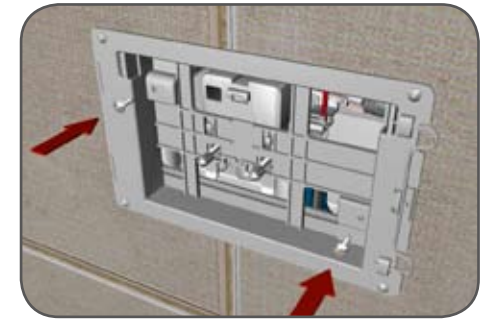
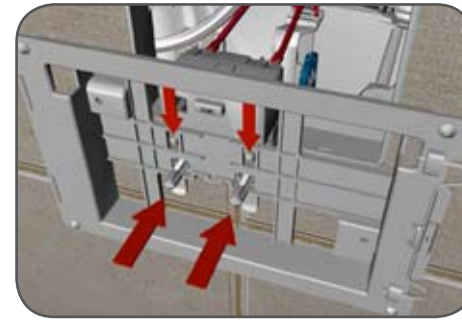

Step 3
Locate the Push Mechanism Box (connected by two wires to the Siphon within the Cistern) and clip the Push Mechanism Box to the Fixing Mount for 0.82/0.98m Cistern (B) by means of the three location slots on the Fixing Mount for 0.82/0.98m Cistern (B).

Step 4
Attach the Fixing Mount for 0.82/0.98m Cistern (B) to the two White Nylon Rods using 2 No. Round Head Screws (C).



Due to our commitment to continuous product development we reserve the right to alter specifications without notice. Products are guaranteed against manufacturing defects for the first purchaser only and the guarantee is non-transferable. Our liability under any guarantee expressed or implied is strictly limited to replacement of defective goods or a refund at our discretion and no consequential losses will be entertained. Proof of purchase will be required.

If you require any assistance or advice, please contact the Helpline on 0845 8 50 50 40

Step 5
Hook the left hand side of the Press Panel (A) over the Fixing Mount for 0.82/0.98m Cistern (B) and push gently to the right so that it clips and holds in position.

Notes
The left Button is for full flush and the right Button is for partial flush.



Due to our commitment to continuous product development we reserve the right to alter specifications without notice. Products are guaranteed against manufacturing defects for the first purchaser only and the guarantee is non-transferable. Our liability under any guarantee expressed or implied is strictly limited to replacement of defective goods or a refund at our discretion and no consequential losses will be entertained. Proof of purchase will be required.

If you require any assistance or advice, please contact the Helpline on 0845 8 50 50 40

Step 5
Hook the left hand side of the Press Panel (A) over the Fixing Mount for 0.82/0.98m Cistern (B) and push gently to the right so that it clips and holds in position.

Notes
The left Button is for full flush and the right Button is for partial flush.



Abacus House,
Jubilee Court, Copgrove, Harrogate, HG3 3TB, England
t: 0845 8 50 50 40 f: 0845 8 50 50 30
e-mail: info@abacusdirect.co.uk

www.abacusdirect.co.uk



Abacus House,
Jubilee Court, Copgrove, Harrogate, HG3 3TB, England
t: 0845 8 50 50 40 f: 0845 8 50 50 30
e-mail: info@abacusdirect.co.uk

www.abacusdirect.co.uk